

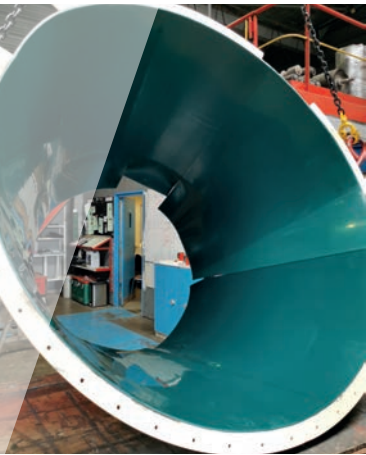

// ONE BRAND // ONE SOURCE // ONE SYSTEM



REMATHAN

High-quality Polyurethane Lining Material

Highly abrasive material - especially with oil or grease content – can cause damage to pipes, hoppers or bunkers. The highly abrasion-resistant lining material **REMATHAN** protects your system against unplanned downtimes and extends system availability.

WEAR PROTECTION RUBBER LININGS

REMATHAN – High-quality Polyurethane Lining Material

Premium wear plates

REMATHAN premium wear protection plates feature extremely high wear resistance and excellent resistance to oil, grease and abrasion.

Properties

- Suitable for highly abrasive applications
- Resistant to oil and grease in oil-based productions
- Easy to attach
- Hydrolysis-resistant
- Microbe-resistant
- High impact elasticity and notch value
- Temperature range from -30°C to +80°C

Application areas

- Oil and grease resistant, wear-resistant linings
- Prevents caking and noise
- Slides, chutes
- Slip ground containers (G 65 /CN and G 75/CN)
- Concrete discharge chutes (G 75 /CN and G 90/CN)

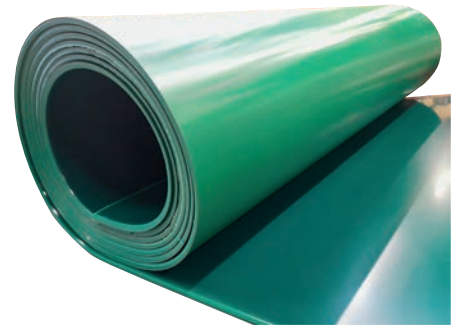

Specifications

| | REMATHAN G 65/CN | REMATHAN G 75/CN | REMATHAN G 90/CN |
|---|----------------------|----------------------|----------------------|
| Abrasion according to DIN ISO 4649 | 12 mm ³ | 14 mm ³ | 25 mm ³ |
| Rebound resilience according to DIN 53512 | 44% | 40% | 36% |
| Tensile strength according to DIN35304 | 29 N/mm ² | 38 N/mm ² | 42 N/mm ² |

Industries



Concrete



Quarries



Sand and gravel



Metal processing



Mining



Coal conveyors



Cement



Recycling

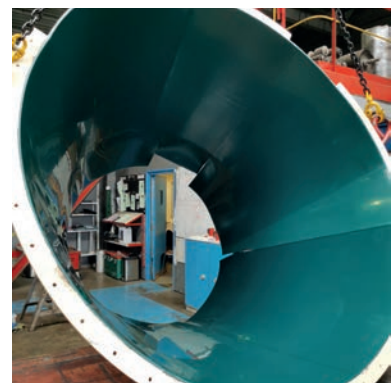
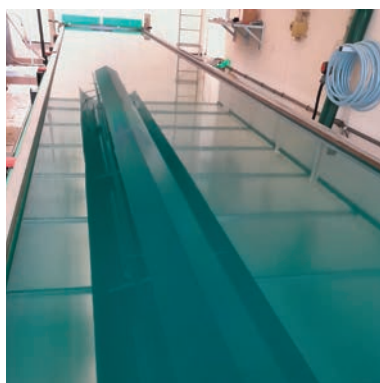
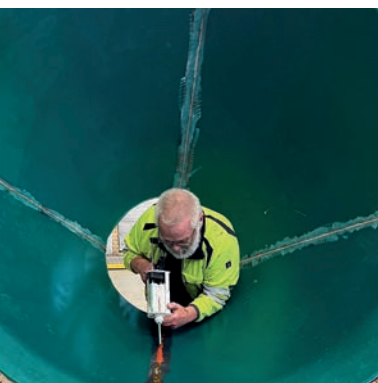

WEAR PROTECTION RUBBER LININGS

REMATHAN – High-quality Polyurethane Lining Material

REMATHAN – Fasting options

1. Bonding with CN layer

for very good corrosion protection of surfaces and prevention of migration

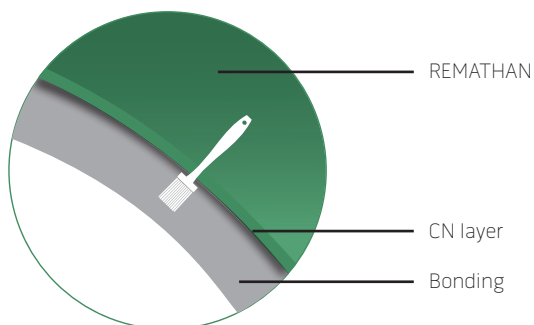

2. Screw fitting with insert

such as perforated sheeting or fabric to prevent the material from tearing and for quick installation

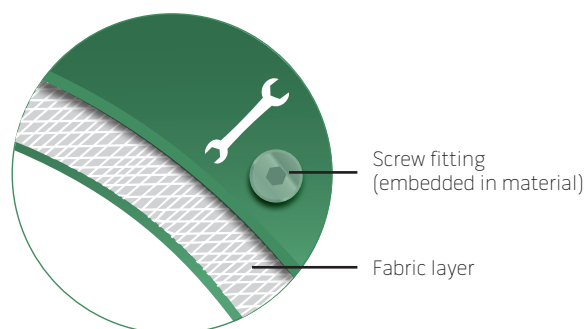
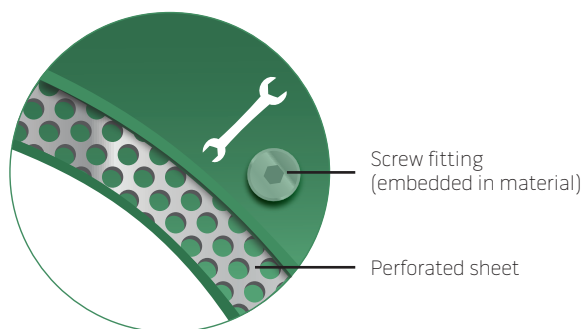

Other inserts such as expansion grids are also possible upon customer request.

3. Screw fitting without insert

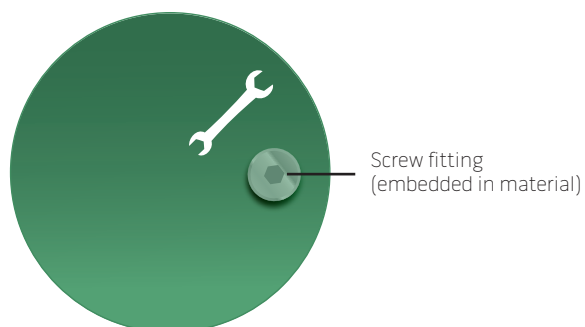



Your local partner



// ONE BRAND // ONE SOURCE // ONE SYSTEM

REMA TIP TOP AG
Gruber Strasse 65 · 85586 Poing / Germany
Phone: +49 8121 707-100
Fax: +49 8121 707-10 222
info@tiptop.de
www.rema-tiptop.com

